



CRUISERS YACHTS

# 54 CANTIUS





# 54 CANTIUS

Awe-inspiring and free-spirited, the 54 Cantius was envisioned for those who live joyously spontaneous lives on and off the water. Three luxurious state rooms, refined appointments and ingenious features all exemplify perfection. But it is the manner in which the 54 Cantius seamlessly integrates living spaces with gentle breezes and starlit nights that truly evokes passion.



## Specifications

	IMPERIAL	METRIC
LOA	54' 7"	16,6 m
BEAM	15' 6"	4,7 m
BRIDGE CLEARANCE (TOP OF MAST LIGHT)	16' 5"	5 m
DRAFT - FULL LOAD	48.5"	1,23 m
FUEL CAPACITY	503 gal	1892 L
WATER CAPACITY	150 gal	568 L
WASTE CAPACITY	70 gal	265 L
WEIGHT - DIESEL (DRY)	43,300 lbs	19776 kg

\*\*\* Weight, Bridge Clearance, Draft subject to change \*\*\*

\*\*\* Consumable liquids may be less than max capacity \*\*\*

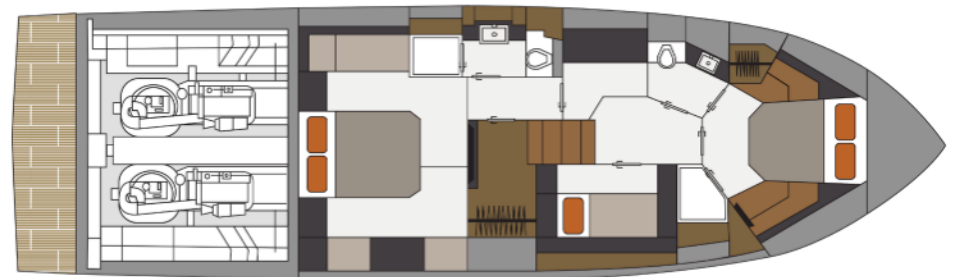
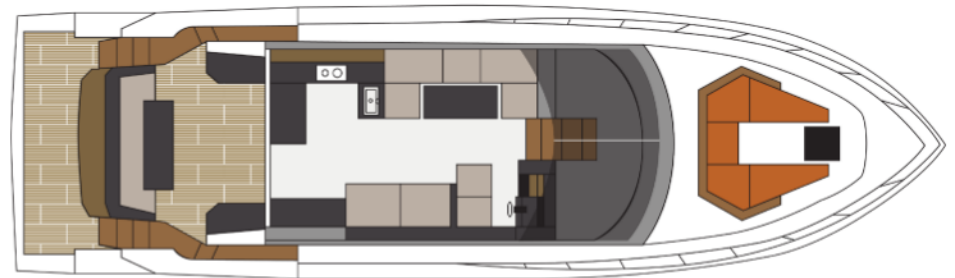

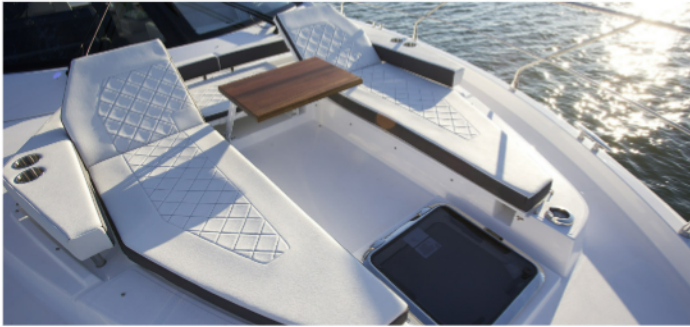

**BOW LOUNGE** – Bask in the warm sun and enjoy a front-seat view from the pop-up lounge chairs of the vast horizon in the 54 Cantius bow lounge. The chairs can be adjusted to your preference and lay flat when not in use.

**COCKPIT** – Dual entry from the swim platform is outfitted with a U-shaped seating area with optional bar stools facing the galley. The wet bar is located on the port side.



**UPPER SALON** – Windows provide 360° views from the open-concept galley, dinette and helm. Retractable windows in the galley open aft to merge interior and exterior spaces, creating endless possibilities for unparalleled entertaining. Rest assured, your guests' time aboard will not soon be forgotten.

**GALLEY** - Cleverly positioned aft to provide optimum entertaining functionality, the galley allows host and guests alike to be at the center of attention. Everyone's favorite feature is sure to be the retractable window that opens the galley to the rear deck for passing refreshments and sharing conversation.

**HELM** – Digital throttles, joystick controlling and a panel with plenty of space for your choice in devices will have you feeling completely in control of this beautiful new yacht.



**MASTER STATEROOM** – The master stateroom onboard the 54 Cantius is a stylishly serene and unusually spacious full-beam retreat. Surrounding the walk-around island berth you will find a café table tucked between two built-in seats, plus built-in nightstands and vanity.

**VIP STATEROOM** – With a walk-around queen berth, generous storage and panoramic windows, the forward stateroom found in the 54 Cantius ensures blissful days and tranquil nights for all. The accompanying head is thoughtfully split with separate head and shower starboard and port.

**THIRD STATEROOM OPTION** – The spacious dual bunk beds provide plenty of space for overnight guests. A large TV, and additional storage make this space a welcome addition.







# 54 CANTIUS

## Standard Features

### Engine Options

Volvo D8, 800IPS, DPS, EVC, 600 HP  
Volvo D11, 950IPS, DPS, EVC, 725 HP

#### HULL COLOR

White

#### INTERIOR COLOR

Sail White

#### WEATHER COVERS

Bow Seat, Chaise Lounge & Cockpit Seat  
Windshield Sun Screen  
Black

#### COCKPIT SEATING COLOR

Pearl White

#### INTERIOR WOOD

Ebony Oak

#### INSTRUMENTS

Compass  
Glass Cockpit  
Helm Seat w/ Companion  
Horn  
Instrumentation  
Remote Spotlight  
Volvo DPS (Digital Positioning System)  
Volvo IPS Diesel  
Volvo IPS Joystick

#### MECHANICAL

AC/DC Panel w/ Voltmeters  
ACR – Auto Charging Relay  
Air Conditioning  
50 lbs Anchor w/ 200' 3/8 HS Chain  
Auto Stabilizing System, 110-230 VAC  
Battery Charging System & Monitor  
Battery Parallel Switch  
Bilge Coating, White  
Bilge Pumps (3), w/ High Water Alarms  
Bonding Systems w/ Transom Zinc  
Bronze Seacocks and Thru Hulls  
On All Underwater Fittings  
Dockside Power – Single 50 Amp Service  
Engine Room Blowers  
Fire Extinguisher, Automatic  
Fire Extinguishers (4)  
Generator – 1.1 kW Onan Diesel Genset  
Generator – Remote Start / Stop  
Ground Fault Interrupt Outlet  
LED Lights  
Master Panel, AC w/ Voltmeters  
Seawater Strainers  
Swim Platform w/ Hydraulic Lift  
Tilt Steering Wheel  
Trim Tabs

#### MAIN DECK

Anchor Roller  
Boarding Gate – Transom (2) and Side Deck Walkways (2)  
Bottom Paint, Anti-Fouling  
Bow Rail, Welded Stainless Steel  
Bow Shade  
Cockpit Lines Storage (Underneath Cockpit Seats)  
Cockpit Shower  
Dockside Water Hookup  
Fiberglass Cockpit, Self Draining  
Gunwale Molding, Stainless Steel  
Hardware, Deck Cleats 10"  
Hatch – Bow w/ Screen and Shade  
Swim Platform w/ Boarding Ladder  
U-Shaped Aft Cockpit Seating  
Windlass  
Windshield Wipers w/ Washdown  
Woven Mat Cockpit Flooring

#### GALLEY / SALON

Cockpit to Salon Entry – Single Level  
Door, Bi-Fold w/ Powered Window  
Exhaust Fan, Galley  
Flooring, Amtico  
Freezer / Ice Maker, Starboard Galley  
Fridge, Port Galley  
Galley Countertop, Solid Surface  
Ice Maker, Starboard Galley  
Microwave / Convection Oven  
Opening Salon Windows w/ Blinds  
Opening Sunroof, Motorized  
Panoramic view Windows  
Salon Seating, U-Shaped Dinette w/Opposed Bench Seating  
Salon TV and Stereo w/ HDMI Outlet  
Stainless Steel Sink w/ Designer Faucet  
Stove, Electric, 2 Burner

#### ACCOMMODATIONS LEVEL

Carpet  
Day Head w/ Private VIP Stateroom Access w/ Separate Adjoining Shower  
Flooring, Amtico, Lower Salon, Ebony Oak  
Master Stateroom, Clothes Locker  
Master Stateroom, Drawer Storage  
Master Stateroom, Head w/ Separate Adjoining Shower  
Master Stateroom, Seating Area  
Master Stateroom, TV & Stereo w/ HDMI  
Master Stateroom, Queen Size Berth  
Third Stateroom  
Third Stateroom TV, 24", Mocha Oak  
VIP Stateroom TV, 28", Mocha Oak  
VIP Stateroom, Queen Size Berth  
Windows – Heads, Opening  
Windows – Master, Large Fixed Glass w/ Opening  
Windows – VIP, Large Fixed Glass w/ Opening

For more information on the 54 Cantius  
or to locate a dealer, please visit  
[cruisersyachts.com](http://cruisersyachts.com)